

# HONDA MAPCARE™

## MAP UPDATE INSTALLATION INSTRUCTIONS

This guide provides the details needed to get the latest update for your Honda navigation system.

For additional languages: [click here](#)

Two convenient map update options are included with your active subscription:

### OPTION 1

Wi-Fi Update (Home or Select Region)

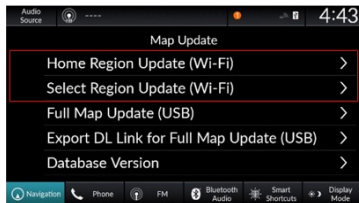

**To get started:**

In your vehicle system, go to **Navigation**, then **Map Update**. For Wi-Fi update instructions, [click here](#).

### OPTION 2

USB Download Update (Full Map Update)



**To get started:**

The rest of this guide contains instructions for the USB download option. Continue to Page 2 to start a USB download.

# HONDA MAPCARE™

## USB DOWNLOAD MAP UPDATE INSTALLATION PROCESS

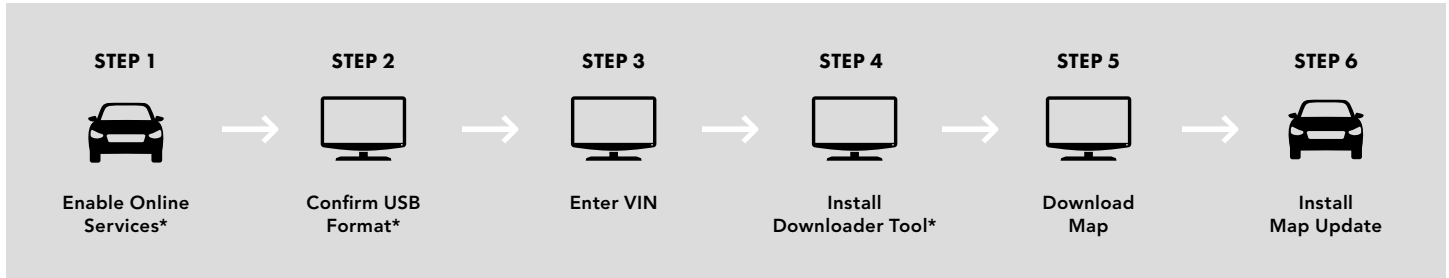

\*Steps may be skipped if already completed.

## WHAT YOU NEED FOR THE INSTALLATION PROCESS

1. VIN (vehicle identification number)
2. Windows computer running Windows 10 or higher or Apple computer running macOS 12 or higher that is connected to the internet
  - You cannot use a Chromebook™ notebook computer, tablet or cellphone
3. Blank USB flash drive (USB stick) formatted to FAT32:
  - Good quality USB flash drive is recommended
  - USB 3.0 or higher is recommended (USB 2.0 will be slower and may cause timeout errors)
  - 32GB is the minimum USB size requirement

Note: Your computer and vehicle may use different USB port types (USB-A or USB-C). Ensure compatibility or use a suitable adapter for data transfer.

## STEP 1

### ENABLE ONLINE SERVICES

🕒 Time: **10 minutes**

📍 Location: **Your vehicle**

1. Connect your vehicle's navigation system to **Wi-Fi**
  - a) Press the **Home** button
  - b) Select **General Settings** → **Connections** → **Wi-Fi** → **OK**
  - c) Choose a Wi-Fi network and enter the password, then select **Connect**



This is the **ONLY** symbol that indicates Wi-Fi is connected. It must be showing to complete registration. (The TCU indicator is **NOT** Wi-Fi.)

2. Press **Navigation**. Press the **Menu** icon (square icon with 3 lines)



## STEP 1 (CONTINUED)

### ENABLE ONLINE SERVICES

3. In the Menu screen, scroll down to **Settings**
4. Select **Online Services** → **Online Service Status**
  - a) If Status says "Signed In," then you can move to Step 2 of this guide
  - b) If Status says "Not Signed Up," go back to previous screen, select **Sign Up for Online Services** and follow the prompts on screen

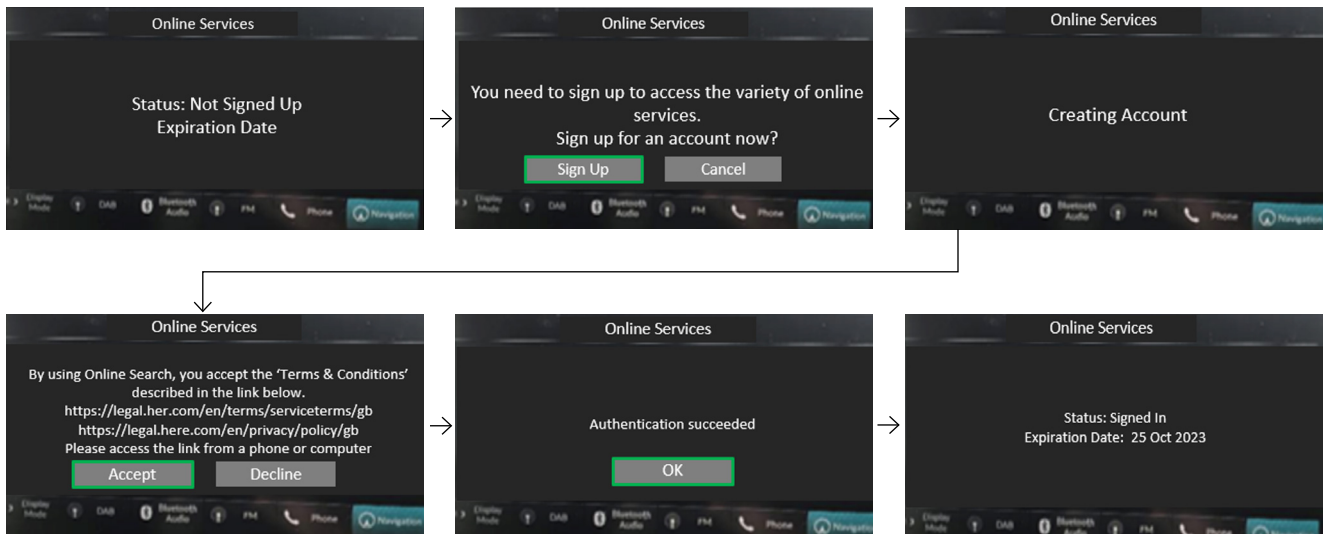
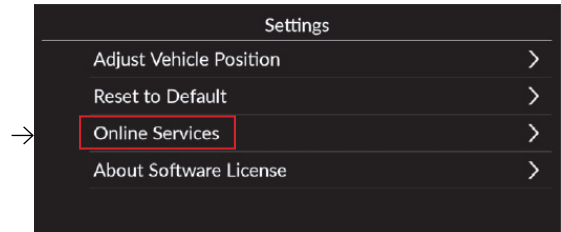

## STEP 2

### CONFIRM USB FORMAT

🕒 Time: **Varies per Windows/macOS**

📍 Location: **Your computer**

1. Check that your USB flash drive is blank. No other files should be on the USB flash drive.
2. Check the format: Your navigation system can only read a **FAT32**-formatted USB flash drive. If your USB drive is already in this format, **skip to Step 3**. Not sure? Here's how to verify it on your Windows computer:

#### VERIFYING FAT32 FORMAT

##### Windows Computers

1. Insert the USB flash drive into your computer
2. Open **File Explorer**, right-click the drive and select **Properties**
3. Confirm the File System reads **FAT32**

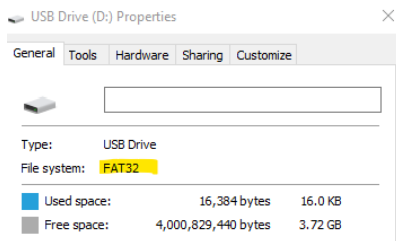

##### MacOS Computers

1. Press **Command (⌘) + Space**
2. Search **Disk Utility** → Open it
3. Click **View** → **Show All Devices**
4. Select the USB drive (not just the volume)
5. Look at the info panel. Confirm the format reads FAT32.

If your USB drive isn't formatted for FAT32, you can format it on your Windows or macOS computer. **Note: Doing this will erase all existing data. Back up important files before proceeding.**

#### FORMATTING A 32GB USB TO FAT32

##### Windows Computers

1. Insert the USB flash drive into your computer
2. Open **File Explorer**, right-click the flash drive and select **Format**
3. Choose **FAT32** from the File System dropdown, then click **Start**

##### MacOS Computers

1. Insert the USB flash drive to be formatted
2. Go to **Applications** → **Utilities** → **Disk Utility**
3. Select your USB flash drive and click **Erase**
4. Name the drive (optional), then set the format to **MS-DOS (FAT)**
5. Set the scheme to **Master Boot Record**, then click **Erase**



Your USB flash drive is now ready. Safely eject it from your computer until you reach **Step 5**.

Need help formatting a USB flash drive **larger than 32GB**? [Click here](#) or go to: <https://hondanavi.navigation.com/hondamapcare>.

## STEP 3

### ENTER YOUR VIN

🕒 Time: **5 minutes**

📍 Location: **Your computer**

1. Go to <https://hondanavi.navigation.com> and enter your **Model** and **Year**
2. Enter your **VIN** on the MapCare™ VIN Entry page
3. Click **Continue** to go to the MapCare™ Download page

## STEP 4

### INSTALL HERE MAP DOWNLOADER TOOL

🕒 Time: **10 minutes**

📍 Location: **Your computer**

The **Map Downloader tool** is a **one-time installation** on your computer that manages the download of large map files and formats them correctly on your USB flash drive, so your vehicle can read and install the update.

To install, click on the "**HERE Map Downloader**" link. Make sure the tool saves directly to your computer and not your USB flash drive.

**Note:** Please download and install [HERE Map Downloader](#) before downloading the map.

**Note:** Installation of the HERE Map Downloader requires computer administrator privileges.

The steps to open the Map Downloader tool vary by computer:

1. After downloading the HERE Map Downloader tool, the file typically appears in one of these places:
  - Your Downloads folder
  - The bottom bar of your web browser
  - A pop-up asking whether to open or run the file
    - If you don't see it immediately, open your **Downloads** folder and look for a file named similar to:  
(Windows) HERE\_Map\_Downloader.exe  
(macOS) HERE\_Map\_Downloader.dmg
2. Start the installation
  - Depending on your computer's settings, one of the following may happen:
    - The installer opens automatically
    - You may need to double-click the file to start it
    - Your computer may ask whether you want to Run, Open or Allow the file
  - Choose **Run** or **Open** to continue
    - If you are asked to "allow website to open a program on your computer," click **Allow**

**Tip:** If the program isn't opening correctly, try a different internet browser.

## STEP 5

### DOWNLOAD MAP UPDATE

🕒 Time: **Varies per internet and USB drive speed; may take several hours**

📍 Location: **Your computer**

1. Click the blue **Download** button on the Honda web store to open the downloader tool and start the download of the latest map update

DOWNLOAD

**Note:** If you see price information instead of the Download button, then your subscription needs to be renewed.

2. **DO NOT** insert your USB flash drive into your computer until prompted, then click **Select**
  - The first screen indicates the data size on the USB after the download has completed ("16.0 GB" is just an example)
3. You can monitor your progress or leave your computer until it's finished. Do not turn off your computer or remove your USB flash drive until the download is complete.

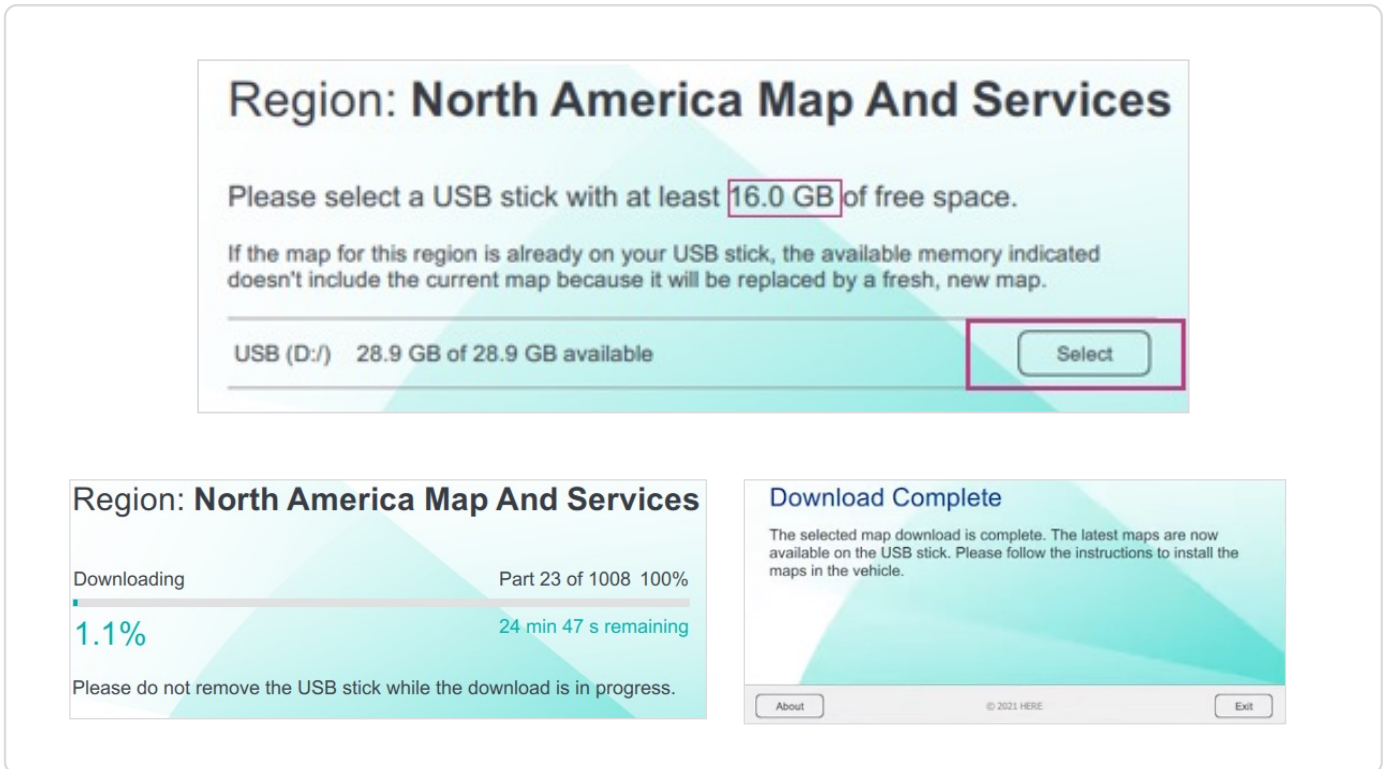

**The new map is loaded on your USB flash drive and ready to be installed.**

If you need to confirm how the files should look on the USB flash drive or would like more details on this step, [click here](#) or go to: <https://hondanavi.navigation.com/hondamapcare>.

# HONDA MAPCARE™

## STEP 6

### UPLOAD/INSTALL MAP UPDATE

🕒 Time: **60–90 minutes**

📍 Location: **Your vehicle**

#### ⊕ Before Starting:

IMPORTANT: Ensure the vehicle is in a well-ventilated area.

It is also recommended to disconnect your phone from Bluetooth® during this process.

1. Turn the vehicle **ON** so that the engine is running
2. With the vehicle in Park, insert your USB flash drive into the **Data** USB port in your vehicle. The Data port is different than the Charging port.
3. While in the **Navigation screen**, press the **Menu** icon.
4. In the **Menu**, scroll down to **Map Update**
5. Press **Full Map Update (USB) → Start Update Process**

The screen will indicate the map is updating and show progress. The update will take up to 90 minutes. A notification will show **the Map update is complete**. Press **OK**.

- You can drive the vehicle while the map update is in process, but you can't use the navigation functions or turn off the engine.

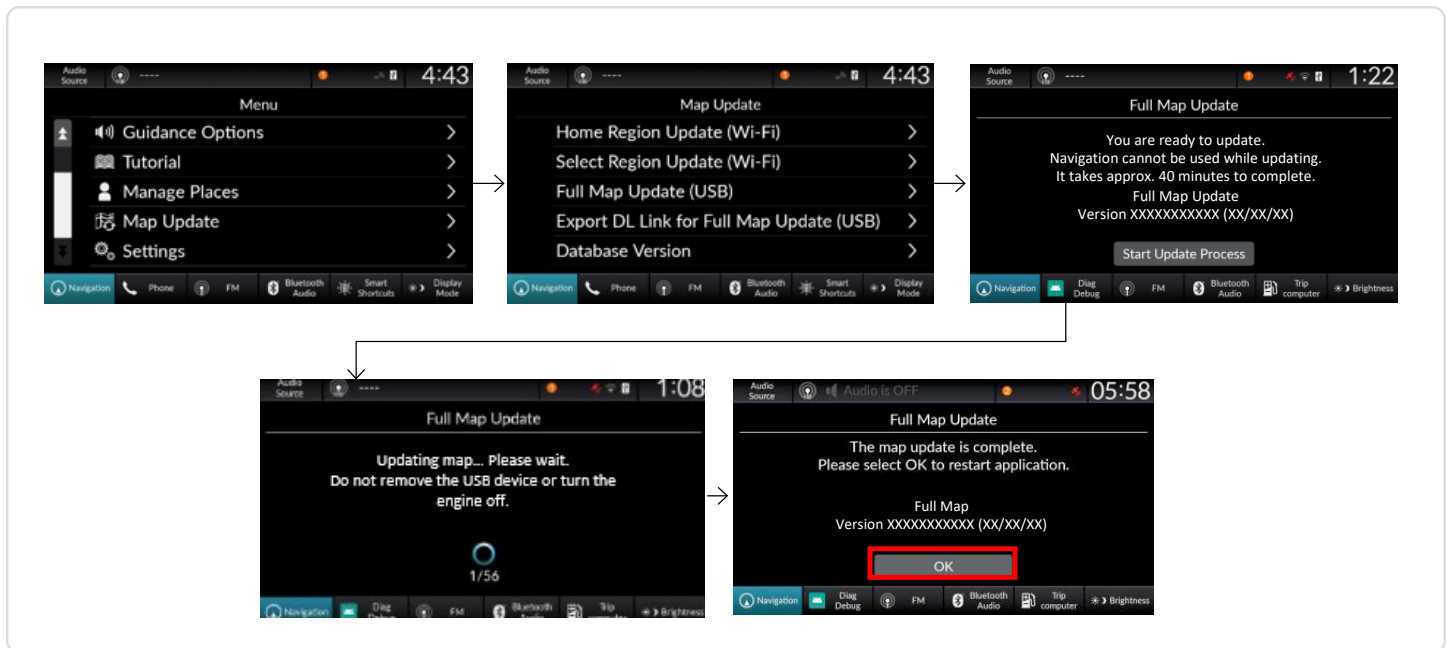
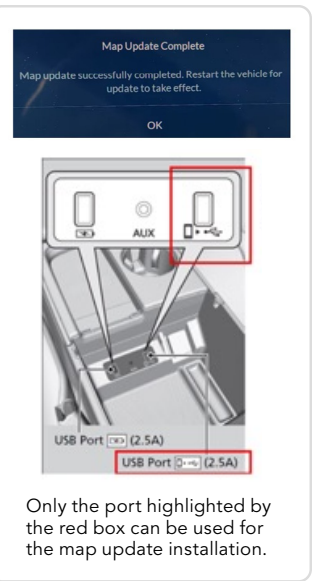

**YOUR MAP UPDATE IS COMPLETE.**